

# Ellie's Quiltplace - Country Calendar

## Assembling the top

Approximately 95 cm x 131 cm

### Requirements

- sashings: 45 cm x 110 cm
- cornerstones: 20 scraps, each 5 cm x 5 cm
- border: 75 cm x 110 cm
- binding: 25 cm x 110 cm
- batting: 105 cm x 140 cm
- backing: 105 cm x 140 cm
- matching sewing and quilting thread

### Cut

**ATTENTION: all measures are WITHOUT seam allowance**

- sashings:
  - o 15 - 3 cm x 17 cm
  - o 16 - 3 cm x 21 cm
- cornerstones: 20 - 3 cm x 3 cm
- border:
  - o 2 - 15 cm x 99 cm
  - o 2 - 15 cm x 93 cm
- binding: 5 cm x 500 cm

### Assembly

Attach the sashing (3 cm x 21 cm) to the left and right side of the blocks and make 4 rows of 3 blocks each. See diagram 1.

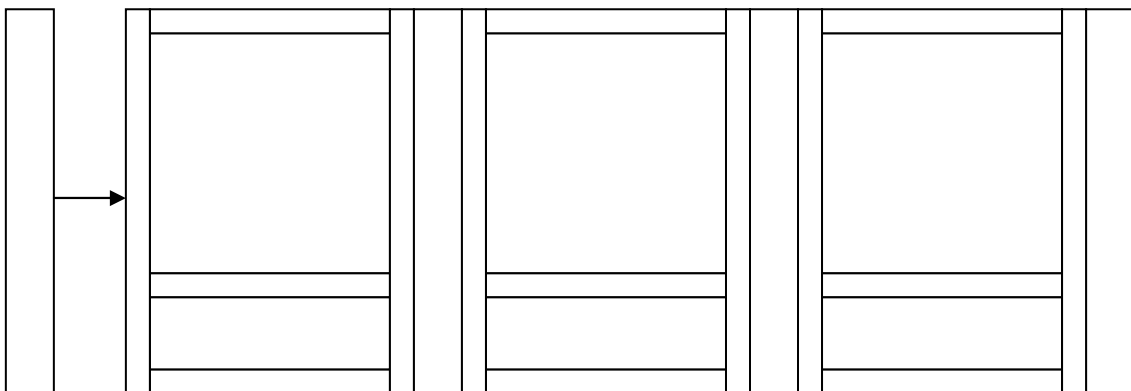

*Diagram 1*

Sew the cornerstones to the sashings of 3 cm x 17 cm according to diagram 2.  
Make 5 rows.

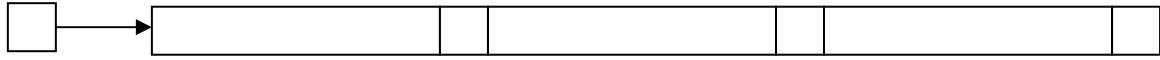

*Diagram 2*

Assemble the top according to diagram 3.

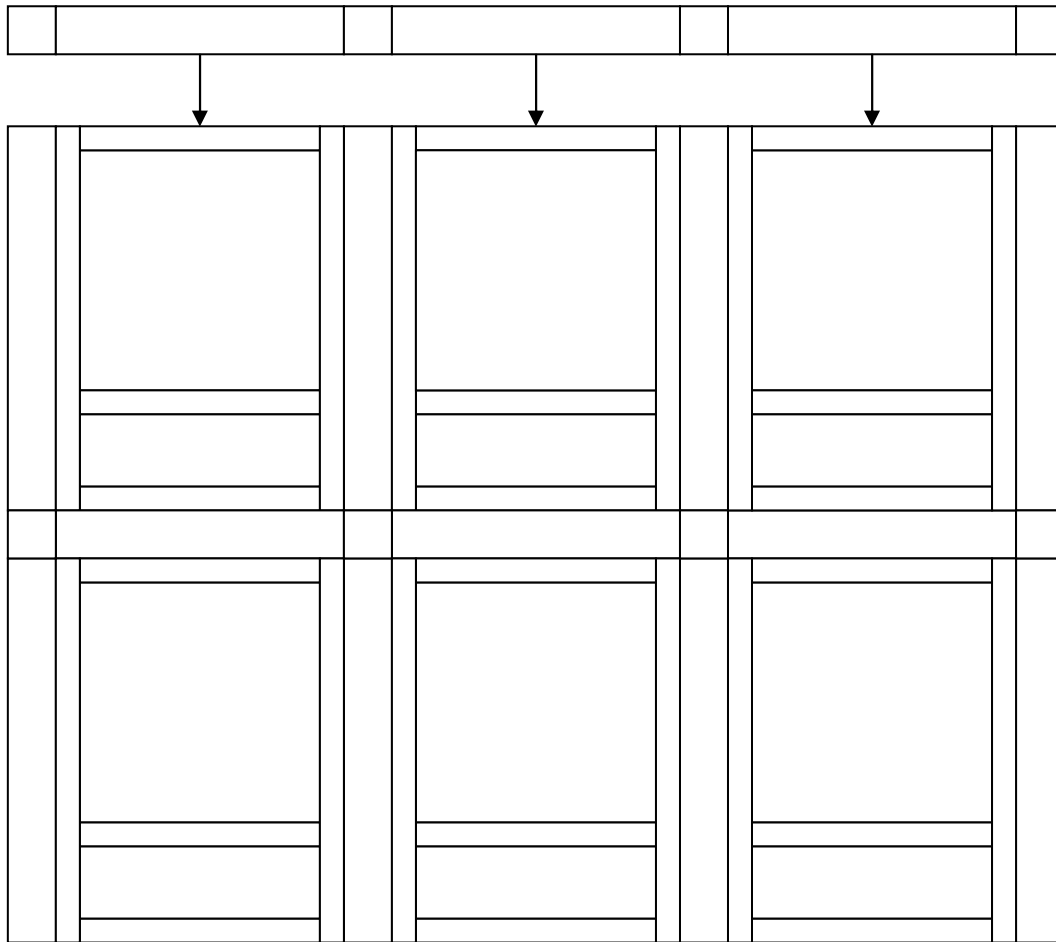

*Diagram 3*

Sew the borders of 15 cm x 99 cm to the left and right side of the centre block and the borders of 15 cm x 93 cm to the top and bottom. See diagram 4.

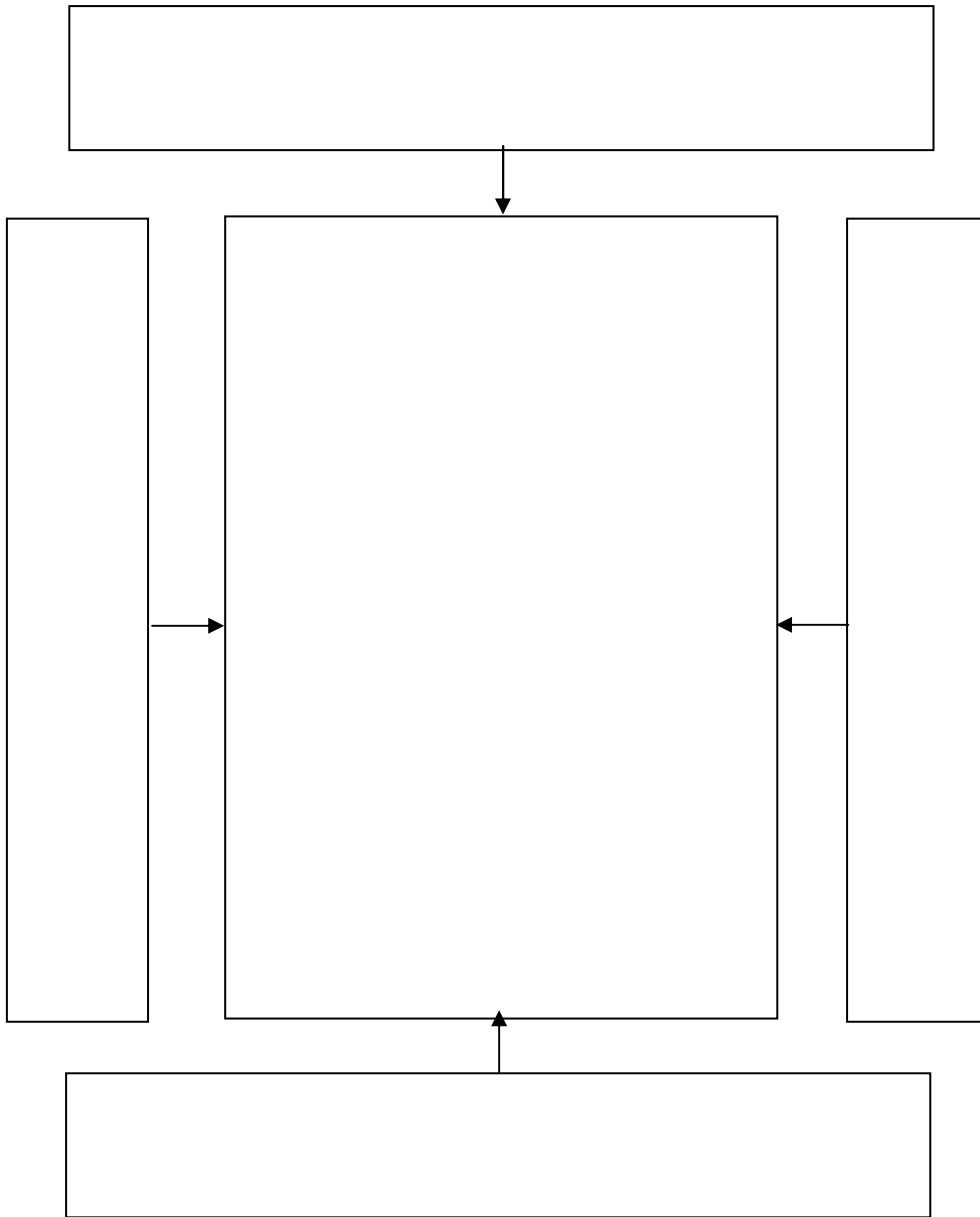
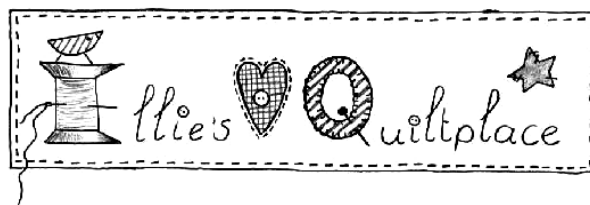

*Diagram 4*

Layer the quilt and quilt as desired.

Finish the quilt according to the 'general instructions'

Happy quilting!



## General Instructions

### Layering the quilt

Iron the quilt top and the backing. The backing and the batting must be approximately 5 inches bigger than the quilt top. Place the backing wrong side up on a flat surface and tape the backing to the surface to keep it in place. Lay the batting on top of the backing and smooth it out evenly. Then add the quilt top, right side up. Pin the three layers together and then baste it, or baste the three layers at once with an upholsterer's needle in horizontal and vertical rows forming a 4-inch grid. Start in the centre of the quilt top and work to the outer edges of the quilt.

### Quilting

Start quilting in the center. Quilt as desired.

### Hanging sleeves

Cut a strip 12 cm wide for a small(er) quilt or 20 cm wide for a bigger quilt by the width of the quilt. Fold the strip lengthwise with right sides together and hem both sides of the strip. Turn the sleeve right side out and press. Place and pin the seam allowance of the sleeve parallel to the seam allowance at the back of the quilt. The seam allowance will be sew together with the binding (see Binding). Hand stitch the other side of the sleeve to the back of the quilt.

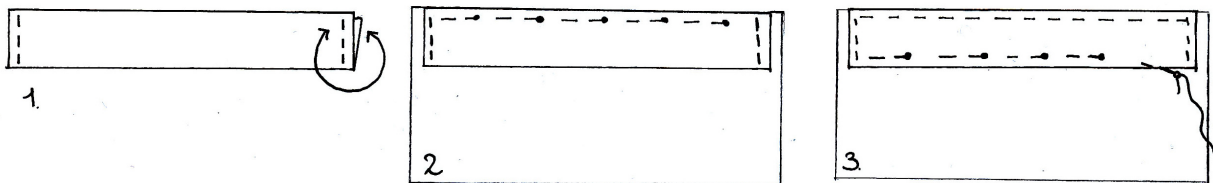

### Binding

Join the strips for the binding end to end to make one long strip. Fold the long strip in half lengthwise, wrong sides together, and press. Stitch the binding strip to the edge of the quilt, using 0,5 cm seam, mitring the corners as you go. Refer to the diagrams below for details.

